

REV.	MODIFICATION	ECN No.	NAME	DATE
AO	新版发行		ERIC	2017-02-24

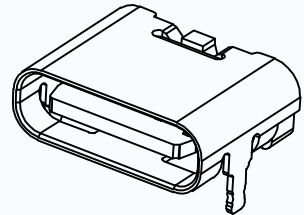
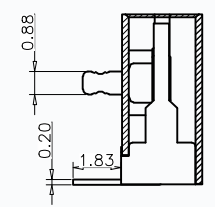
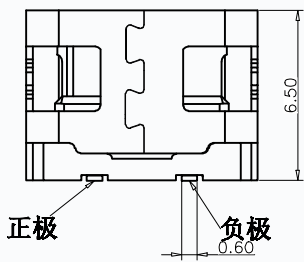

备注 (NOTE):

1 材质:

- 1.1 胶芯: LCP UL94 V-0
- 1.2 端子: C2680, T=0.2mm; 镍底, 镀金
- 1.3 外壳: 不锈钢201-H 表面镀镍

2 电气特性:

- 2.1 接触区: 接触电阻40mΩ Max, 允许10mΩ变化量. 测试条件: 20mv, 100mA下测量.
- 2.2 接触电流: 3A VBUS引脚; 1.25A用于GND引脚; 其他引脚为0.25A.

2.3 额定电压: 5V.

2.4 耐电电压: 100VAC.

2.5 绝缘电阻: 至少100兆欧.

3 机械性能:

- 3.1 插入力: 0.5-2.0Kg
- 3.2 拔出力: 0.6-2.04Kg
- 3.3 插拔次数: 5000次.
- 4. 工作环境: -20℃ to +85℃.

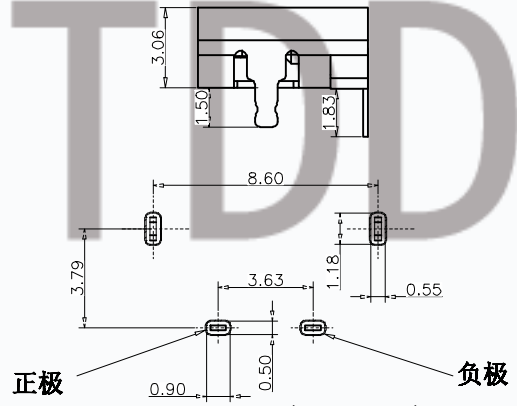
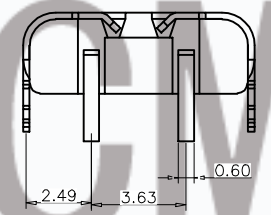
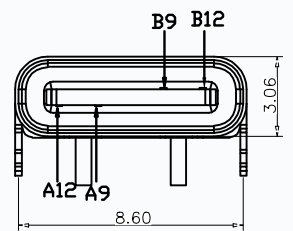

RECOMMEND P.C.B LAYOUT (COMPONENT SIDE)
TOLERANCE FOR PCB LAYOUT IS ±0.05

USB TYPE C PIN ASSIGNMENTS

PIN NUMBER	SIGNAL NAME	PIN NUMBER	SIGNAL NAME
		B12	GND
		B9	VBUS
A5	CC1		
		B5	CC2
A9	VBUS		
A12	GND		

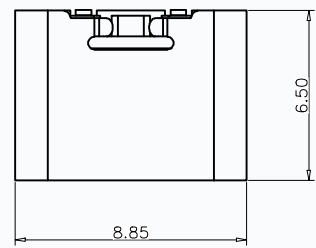

TABLE:

NO	PART	Q'TY	Material
1	SHELL	1	ZINC ALLOY, NI30u"Min PLATED
2	CONTACT	6	C2680, TIN80u"/Au1u"/NI30u" PLATED
3	IMD HOUSING	1	LCP UL94 V-0 BLACK
4	CAP	1	LCP UL94 V-0 BLACK
5	WATERPROOF RING	1	SILICONE UL94 V-0 BLACK

CMTDDZ 东莞市田都科技有限公司
Dongguan TianDu Technology Co. Ltd.

.X: ±0.35	.X': ±1.5°	INTENDED USE:	TITLE:
.XX: ±0.25	.XX': ±1.0°	CONNECTOR	TYPE-C 2P 90度母座
.XXX: ±0.20	.XXX': ±0.5°	APPD.:	PART NO.:
			SEE TABLE
MAT'L.:	SEE NOTES	CHKD.:	DWG. NO.:
			T11-02BS01
FINISH:		DR.:	SCALE: 1:1
		ERIC	PAGE: 1/1
			UNIT: mm
			REV.: AO