

Rev No.	Description of Revision	Date	Name	Approved	ECN No.
▲X					

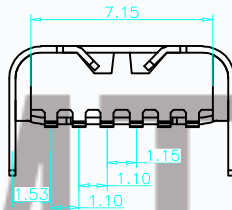

CMTDDZ

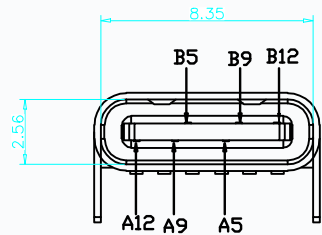
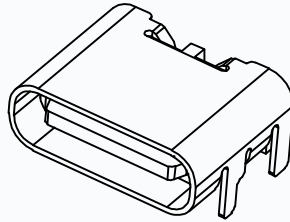
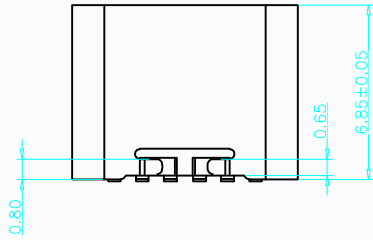
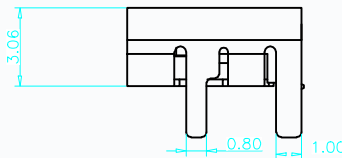
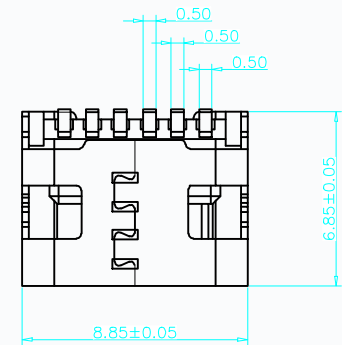

**备注 (NOTE):**

**1. 材质:**

- 1.1 胶芯: LCP UL94 V-0
- 1.2 端子: C2680, T=0.2mm; 镍底, 镀金
- 1.3 外壳: 不锈钢201-H 表面镀镍

**2. 电气特性:**

- 2.1 接触区: 接触电阻40mΩ Max, 允许10mΩ变化量. 测试条件: 20mv, 100mA下测量.
- 2.2 接触电流: 3A VBUS引脚; 1.25A用于GND引脚; 其他引脚为0.25A.

**2.3. 额定电压: 5V.**

**2.4. 耐电电压: 100VAC.**

**2.5. 绝缘电阻: 至少100兆欧 .**

**3. 机械性能:**

- 3.1. 插入力: 0.5-2.0Kg
- 3.2. 拔出力: 0.6-2.04Kg
- 3.3. 插拔次数: 5000次.
- 4. 工作环境: -20℃ to +85℃.

**USB TYPE C PIN ASSIGNMENTS**

PIN NUMBER	SIGNAL NAME	PIN NUMBER	SIGNAL
		B12	GND
		B9	VBUS
A5	CC1		
		B5	CC2
A9	VBUS		
A12	GND		

PART	Q'TY	Material
SHELL	1	ZINC ALLOY, NI30u"Min PLATED
CONTACT	6	C2680, TIN80u"/Au1u"/NI30u" PLATED
1MD HOUSING	1	LCP UL94 V-0 BLACK
CAP	1	LCP UL94 V-0 BLACK
WATERPROOF RING	1	SILICONE UL94 V-0 BLACK

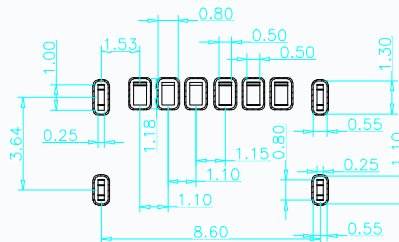

RECOMMEND P.C.B LAYOUT (COMPONENT SIDE)  
TOLERANCE FOR PCB LAYOUT IS ±0.05

UNLESS OTHERWISE SPECIFIED TOLERANCES		<b>CMTDDZ 东莞市田都科技有限公司</b> DONGGUAN TIANDU TECHNOLOGU CO., LTD			
DECIMALS:	ANGLES	<b>TYPE-C6P板上无弹2.0脚</b>			
X. ±0.20	X'. ±2'	Drwn. ERIC	PART NO. T11-06BS17A-6&L-4-20		
X.X ±0.15	X.X' ±1'	Checked. JEFF	SCALE. 1:8	UNIT. mm	PROJ.
X.XX ±0.10	X.XX' ±0.5'	Approved.	SIZE. A4	SHEET. 1 OF 1	REV. A
X.XXX ±0.05		CUSTOMER COPY			