

|    |       |           |    |    |    |
|----|-------|-----------|----|----|----|
| 版次 | 变更摘要  | 日期        | 序号 | 品名 | 材质 |
| 0  | 新产品发行 | 2015/1/28 |    |    |    |

|   |                |                |
|---|----------------|----------------|
| ① | 0.5掀盖胶芯 (H1.2) | LCP UL94V-0 本色 |
| ② | 0.5掀盖端子 (H1.2) | 铜合金/表面镀锡<br>镀金 |
| ③ | 0.5掀盖后盖 (H1.2) | LCP UL94V-0 黑色 |
| ④ | 0.5掀盖焊片 (H1.2) | 铜合金/表面镀锡       |

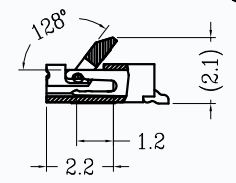

SECTION A-A

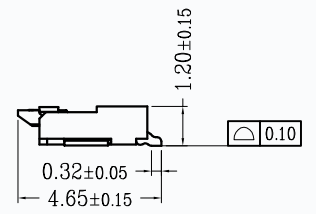
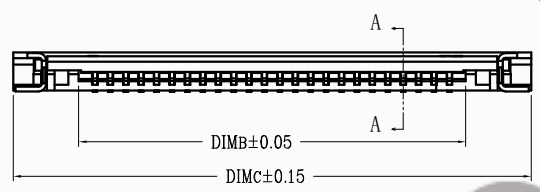
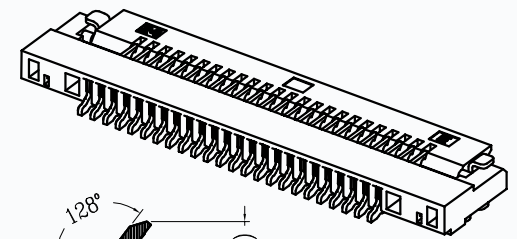
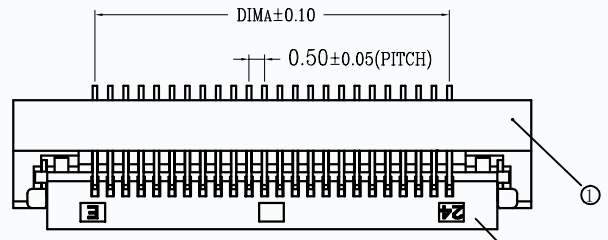
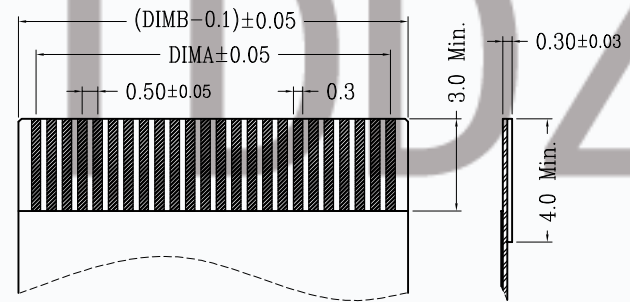
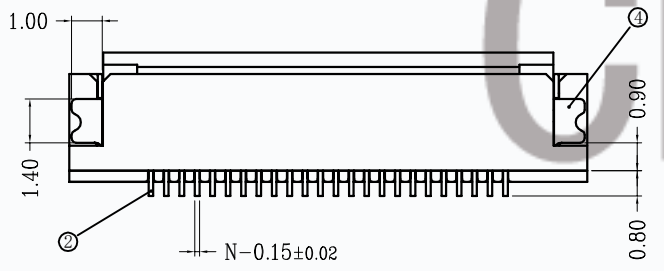

适用扁平线(Applicable Flat Cable)

| CKT | DIMA  | DIMB  | DIMC  | CKT | DIMA  | DIMB  | DIMC  |
|-----|-------|-------|-------|-----|-------|-------|-------|
| 4   | 1.50  | 2.55  | 6.80  | 33  | 16.00 | 17.05 | 21.30 |
| 5   | 2.00  | 3.05  | 7.30  | 34  | 16.50 | 17.55 | 21.80 |
| 6   | 2.50  | 3.55  | 7.80  | 35  | 17.00 | 18.05 | 22.30 |
| 7   | 3.00  | 4.05  | 8.30  | 36  | 17.50 | 18.55 | 22.80 |
| 8   | 3.50  | 4.55  | 8.80  | 37  | 18.00 | 19.05 | 23.30 |
| 9   | 4.00  | 5.05  | 9.30  | 38  | 18.50 | 19.55 | 23.80 |
| 10  | 4.50  | 5.55  | 9.80  | 39  | 19.00 | 20.05 | 24.30 |
| 11  | 5.00  | 6.05  | 10.30 | 40  | 19.50 | 20.55 | 24.80 |
| 12  | 5.50  | 6.55  | 10.80 | 41  | 20.00 | 21.05 | 25.30 |
| 13  | 6.00  | 7.05  | 11.30 | 42  | 20.50 | 21.55 | 25.80 |
| 14  | 6.50  | 7.55  | 11.80 | 43  | 21.00 | 22.05 | 26.30 |
| 15  | 7.00  | 8.05  | 12.30 | 44  | 21.50 | 22.55 | 26.80 |
| 16  | 7.50  | 8.55  | 12.80 | 45  | 22.00 | 23.05 | 27.30 |
| 17  | 8.00  | 9.05  | 13.30 | 46  | 22.50 | 23.55 | 27.80 |
| 18  | 8.50  | 9.55  | 13.80 | 47  | 23.00 | 24.05 | 28.30 |
| 19  | 9.00  | 10.05 | 14.30 | 48  | 23.50 | 24.55 | 28.80 |
| 20  | 9.50  | 10.55 | 14.80 | 49  | 24.00 | 25.05 | 29.30 |
| 21  | 10.00 | 11.05 | 15.30 | 50  | 24.50 | 25.55 | 29.80 |
| 22  | 10.50 | 11.55 | 15.80 | 51  | 25.00 | 26.05 | 30.30 |
| 23  | 11.00 | 12.05 | 16.30 | 52  | 25.50 | 26.55 | 30.80 |
| 24  | 11.50 | 12.55 | 16.80 | 53  | 26.00 | 27.05 | 31.30 |
| 25  | 12.00 | 13.05 | 17.30 | 54  | 26.50 | 27.55 | 31.80 |
| 26  | 12.50 | 13.55 | 17.80 | 55  | 27.00 | 28.05 | 32.30 |
| 27  | 13.00 | 14.05 | 18.30 | 56  | 27.50 | 28.55 | 32.80 |
| 28  | 13.50 | 14.55 | 18.80 | 57  | 28.00 | 29.05 | 33.30 |
| 29  | 14.00 | 15.05 | 19.30 | 58  | 28.50 | 29.55 | 33.80 |
| 30  | 14.50 | 15.55 | 19.80 | 59  | 29.00 | 30.05 | 34.30 |
| 31  | 15.00 | 16.05 | 20.30 | 60  | 29.50 | 30.55 | 34.80 |
| 32  | 15.50 | 16.55 | 20.80 |     |       |       |       |

技术指标:

1. 塑件表面应光洁、无毛边、无明显收缩、缺陷、裂纹等现象。
2. 温度范围: -25° C~85° C.
3. 额定电压: 50V, AC/DC(等效)。
4. 接触电阻: ≤0.03Ω.
5. 绝缘电阻: ≥500MΩ
6. 产品料号:

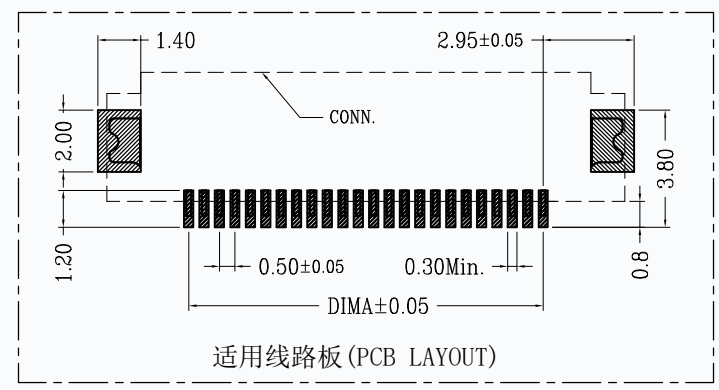

适用线路板(PCB LAYOUT)

T17-0512QX-\*\*-\*\*-\*\*

NO OF CKT (产品PIN数)      \*\*      \*      \*-\*\*

Plating (电镀方式)      \*\*      \*      \*-\*\*

Packing (包装方式)

0: 端子全雾锡      T: TUBE管装

1: 端子全金(G/F OVERALL)      R: TAPE & REEL卷装

5: 端子半金锡

OO 后盖有LOGO:TD  
OW 后盖无LOGO



一般公差 (TOLERANCE)

X ±.50    .XX ±.10

X ±.20    .XXX ±.05

ANGLES    ±1°

**CMTDDZ 东莞市田都科技有限公司**  
Dongguan TianDu Technology Co. Ltd.

|             |                         |            |      |
|-------------|-------------------------|------------|------|
| 品名 (TITLE)  | 0.5 Pitch掀盖卧式下接 (H=1.2) | 制图 (DR)    | ERIC |
| 料号 (DWG.NO) | T17-0512QX-**-**-**     | 校对 (CHKD)  |      |
| 比例 (SCALE)  | 1:1                     | 单位 (UNITS) | mm   |
| 张数 (SHEET)  | 1 OF 1                  | 尺寸 (SIZE)  | A4   |
| 审核 (APPD)   |                         | REV        | A    |