

- SPECIFICATIONS:
- ELECTRICAL CHARACTERISTICS:
    - CONTACT RESISTANCE: 30mΩ MAX.
    - DIELECTRIC WITHSTANDING VOLTAGE: 100V AC FOR ONE MINUTE.
    - INSULATION RESISTANCE: 100MΩ MIN. MEASURED BY 500 VDC
  - MECHANICAL CHARACTERISTICS:
    - INSERTION FORCE :0.5-2.0kgf(REF.)
    - WITHDRAWAL FORCE :0.8-2.0kgf(REF.)
  - LIFE TEST: 10,000 CYCLES.

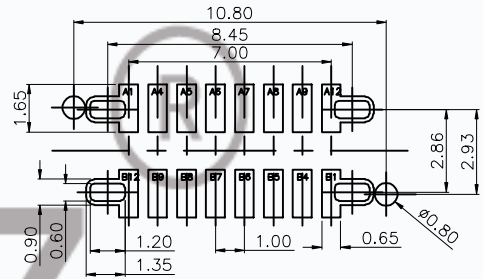

RECOMMENDED P.C.B. LAYOUT (T:1.00mm)  
TOLERANCE UNSPECIFIED ±0.05mm

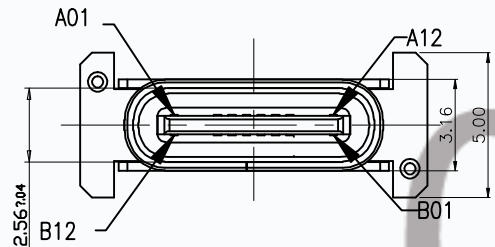
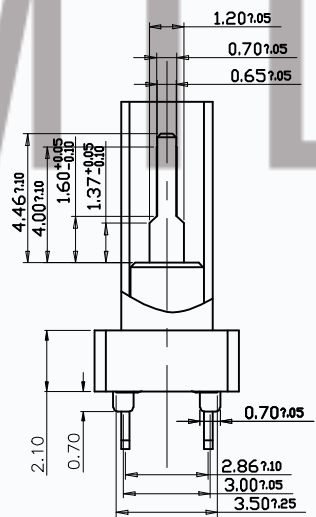
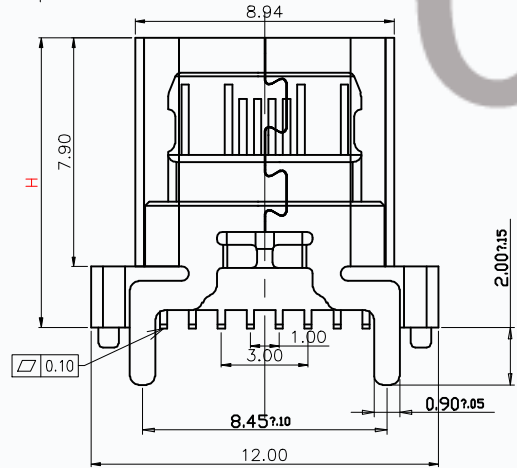

H(mm)
8.8
9.3
10
10.5
12.4
13.1
13.7
15
17.5

A1	GND	B12	GND
A4	VBUS	B9	VBUS
A5	CC1	B8	SB12
A6	DPI	B7	DN2
A7	DM	B6	DP2
A8	SB11	B5	CC2
A9	VBUS	B4	VBUS
A12	GND	B1	GND
PIN	SIGNAL NAME	PIN	SIGNAL NAME

**CMTDDZ 东莞市田都科技有限公司**  
Dongguan TianDu Technology Co. Ltd.

品名 (ITEM NO)	TYPE-C 16PIN 母座 立式贴板 (H=8.8/9.3/10/10.5/12.4/13.1/13.7/15.0/17.5mm)
料号 (PART NO)	T11-16LS02-H
模号 (MODEL NO)	

图号 (DWG NO)		单位 (UNIT):	MM
版本 (REV)	A/1	比例 (SCALE)	1:1
日期 (DATE)	2020. 11. 27		
设计 (DESIGN)	ERIC		
审核 (CHECKED)	~	未注公差	
核准 (APPROVED)		Tolerance Unspecified I X ±0.30 I XX ±0.15 I XXX ±0.10 I* ±0.5 I X* ±0.2	