

GP Component

REV.	ECN NO.	LOCATIONS	DESCRIPTION	DATE	DESIGN
A0			原始版本(INITIAL EDITION)	2020.12.15	ERIC

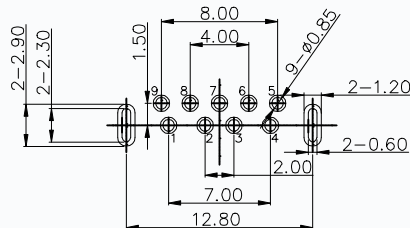
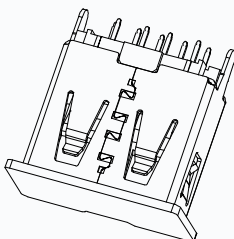
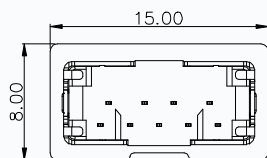

Pin NUMBER	SIGNAL NAME
1	VBUS
2	D-
3	D+
4	GND
5	StdA_SSRX-
6	StdA_SSRX+
7	GND_DRAIN
8	StdA_SSTX-
9	StdA_SSTX+
Shell	Shield

RECOMMENDED P.C.B LAYOUT, T=1.20mm
P.C.B TOLERANCES ±0.05mm
(TOP VIEW)

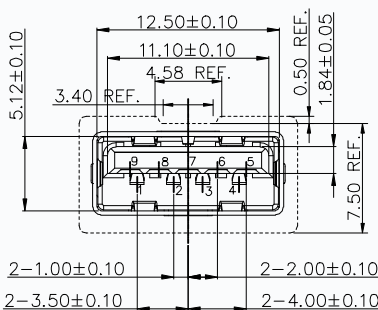
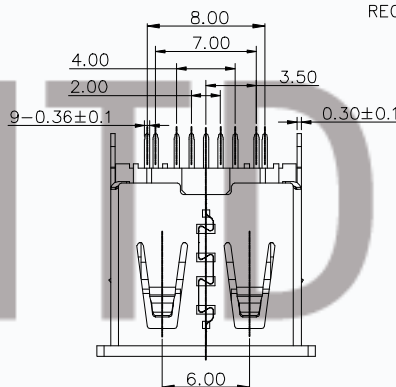
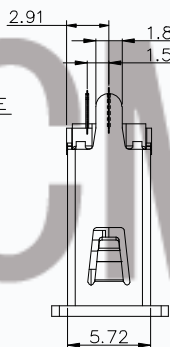
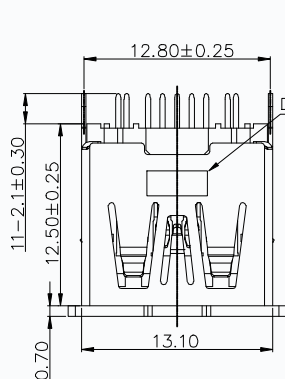

- NOTE:
- MATERIAL:
HOUSING/CAP: LCP, UL94V-0; COLOR: BLACK
CONTACTS: C5191 T=0.2MM
SHELL: SUS 201 T=0.3MM
 - PLATING:
CONTACTS: GOLD(SEE TABLE)PLATED ON CONTACT AREA, 100u", MATTE-TIN ON SOLDERTALLS 50u", NICKEL UNDERPLATING OVER ALL
SHIELD: 50u", NICKEL UNDERPLATING OVER ALL
 - ELECTRICAL CHARACTERISTICS:
3.1 CURRENT RATING:1.8A (PIN 1,4); OTHER CONTACTS 0.25A
3.2 CONTACT RESISTANCE 30mΩ Max.
3.3 DIELECTRIC WITHSTANDING VOLTAGE:100V AC FOR 1 MINUTE
3.4 INSULATION RESISTANCE:100MΩ MIN.
3.5 OPERATING TEMPERATURE:-20°C ~ 60°C
 - MECHANICAL CHARACTERISTICS:
4.1 MATING FORCE:35 N Max
4.2 UNMATED FORCE:10 N Min INITIAL; 8 N Min AFTER TEST
4.3 DURABILITY:5,000 CYCLES
 - Salt Spray 24H
 - RESISTANCE TO REFLOW SOLDERING HEAT: 260°+0/-5,10s.

CMTDDZ 东莞市田都科技有限公司 Dongguan TianDu Technology Co. Ltd.

TOLERANCE: X ±0.30 XX ±0.25 XXX ±0.15 X* ±1° XX* ±0.5°	DESIGN BY :	DATE :	PART NAME:	
	ERIC	2020.12.15	USB 3.0 AF 180° DIP 无卷边 直脚2.1 B=12.6 引脚长2.1 (不带锁壳)	
 UNIT: mm [inch] SCALE:1:1 SIZE:A4	CHECKED BY:	DATE :	PART NO.	T10-3F180D
	APPROVED BY:	DATE :	MOLD NO.	
			DRAW NO.	
			SHEET NO.	01 OF 02