

GP Component

REV.	ECN NO.	LOCATIONS	DESCRIPTION	DATE	DESIGN
A0			原始版本(INITIAL EDITION)	2020.12.15	ERIC

Date Code:
YY MM DD
DATE
MONTH
YEAR

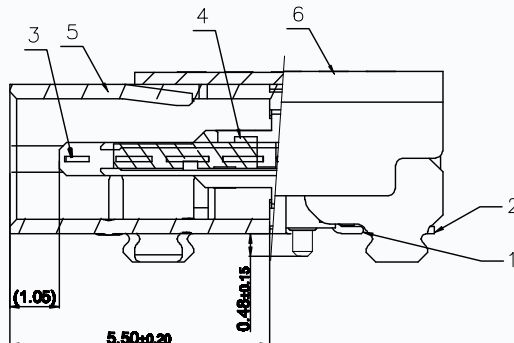
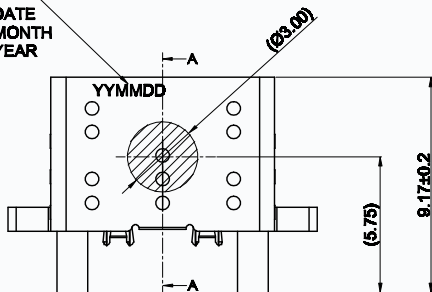

Pin定义:

A1	A2	A3	A4	A5	A6	A7	A8	A9	A10	A11	A12
GND	TX1+	TX1-	Vbus	CC1	D+	D-	SBU1	Vbus	RX2-	RX2+	GND
GND	RX1+	RX1-	Vbus	SBU2	D-	D+	CC2	Vbus	TX2-	TX2+	GND
B12	B11	B10	B9	B8	B7	B6	B5	B4	B3	B2	B1



SECTION A-A(剖视图A-A)
SCALE 2:1 (比例 2:1)

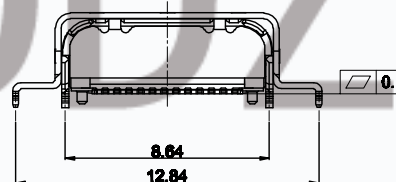
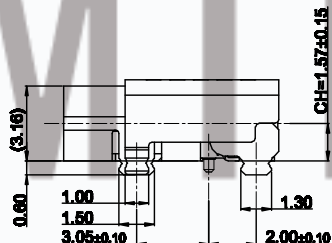
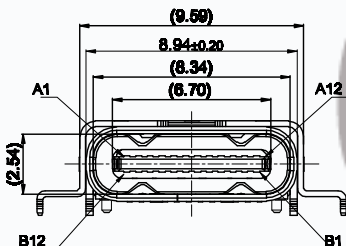

MATED CONDITION(REF.)

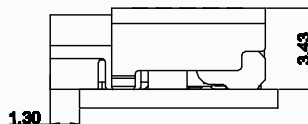
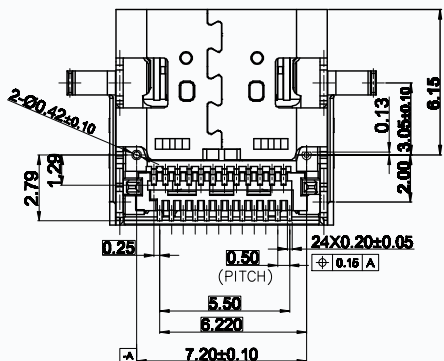

MOUNTING CONDITION(REF.)

ITEM	DESCRIPTION	QTY	MATERIAL	REMARK
6	OUT SHELL	1	SUS304	NICKEL PLATING 0.25mm
5	INT SHELL	1	SUS304	NICKEL PLATING 0.2mm
4	MAIN HOUSING	1	PART: HF 50%REF. ULM V4. 黑色	COLOR:BLACK
3	MID PLATE	1	SUS301	0.15mm
2	BOTTOM TERMINAL	1	C18140	MATING SIDE:SEE PART NO. 0.12mm
1	TOP TERMINAL	1	C18140	SOLDER TAIL:GOLD FLASH, 30μm NICKEL OVERALL. 0.12mm

CMTDDZ 东莞市田都科技有限公司
Dongguan TianDu Technology Co. Ltd.

TOLERANCE: X ±0.30 XX ±0.25 XXX ±0.15 XXXX ±0.10 X° ±1° X.X° ±0.5°	DESIGN BY :	DATE :	PART NAME: USB Type C 3.1 母座 双壳 双贴SMT 板上平贴, L=9.17mm	
	CHECKED BY :	DATE :	PART NO.:	T11-248900
 UNIT: mm [inch] SCALE: 1:1 SIZE: A4	APPROVED BY :	DATE :	MOLD NO.:	
			DRAW NO.:	
			SHEET NO.:	01 OF 02