

WITHOUT COVER

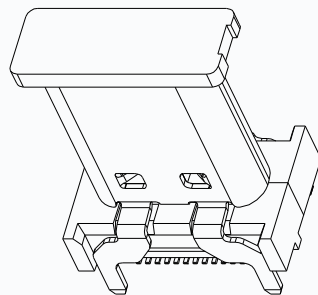

WITH COVER

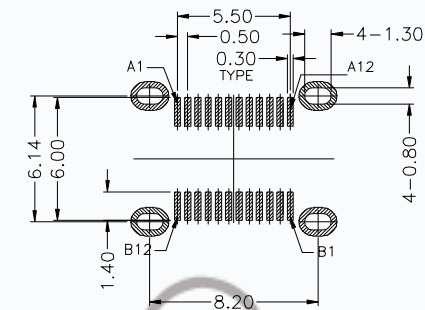

RECOMMEND P.C.B LAYOUT (COMPONENT SIDE)

TOLERANCE FOR PCB LAYOUT IS ± 0.05

KEEP OUT AREA

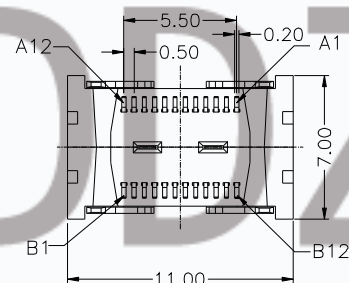
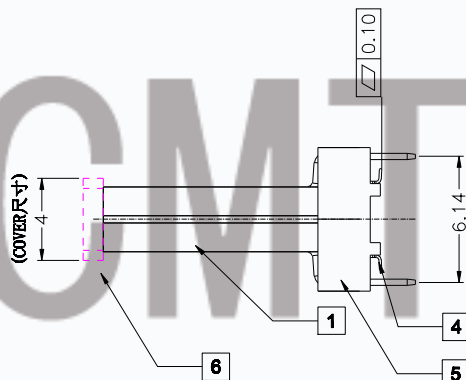
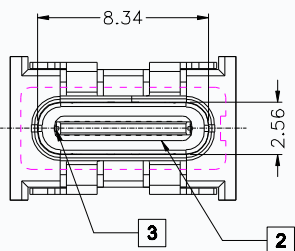

T11-24LS07-13.5H-XX-R

Mating Area plating

- 01: Au 1u"Min.
- 03: Au 3u"Min.
- 05: Au 5u"Min.
- 10: Au 10u"Min.
- 15: Au 15u"Min.
- 30: Au 30u"Min.

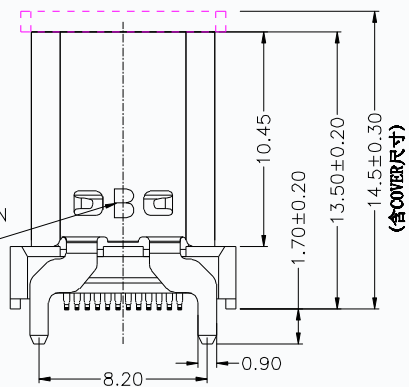

1. Contact Resistance: 40mOHM Max.;
2. Dielectric Withstanding Voltage: 100V AC For 1 Minute;
3. Insulation Resistance: 100M OHM Min.;
4. Mating And Unmating Force:
Mating Force: 5~20N
Unmating Force: 8~20N;
6~20N AFTER TEST;
5. Durability: 10000 Cycles;

Item	Title	Material	Dispose	Q'TY
1	Shell	SUS304	Ni:30u" Min.	1PCS
2	GND Plate	SUS301		2PCS
3	Mid Plate	SUS301		1PCS
4	Contact	C7025	Mating Area: See P/N Solder Tails: Matt Tin	2PCS
5	InsertMolding	LCP E6808	UL 94V-0 Black	1PCS
6	COVER	LCP E6808	UL 94V-0 Black	1PCS

X. ± 0.35	APPD: JEFF	TITLE: USB 3.1 TYPE C FEMALE VERTICAL H13.5mm SMT TYPE	PART NO: T11-24LS07-13.5H
.X ± 0.25	CHKD: /		
.XX ± 0.15			
.XXX ± 0.10			
X' $\pm 2^{\circ}$	DR: ERIC	CMTDDZ 东莞市田都科技有限公司 Dongguan TianDu Technology Co. Ltd.	
X" $\pm 1.5^{\circ}$		DWG NO: CUSTOMER DRAWING	SHEET: 10F1
	UNITS: mm	SCALE: 3:1	REV: A

REV	ECN NO	DESCRIPTION	DESIGN	DATE
A	TD2020-XXXX	New Drawing	ERIC	2020/03/30