

RoHS

REV.	ECN.NO.	APPD.
A	—	ERIC

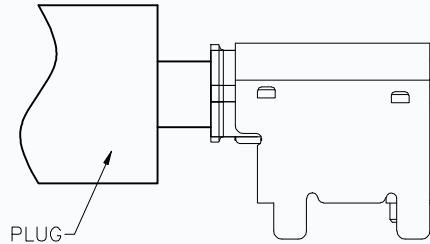

AFTER MATING

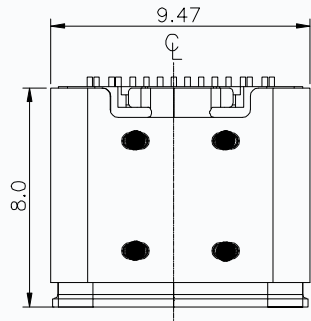
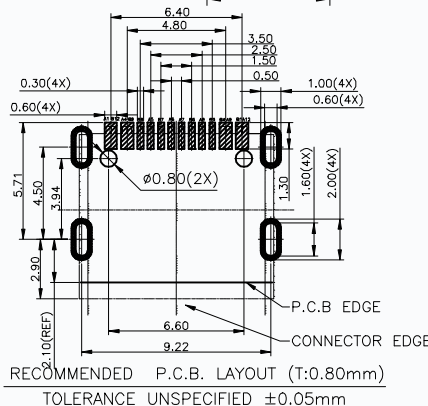
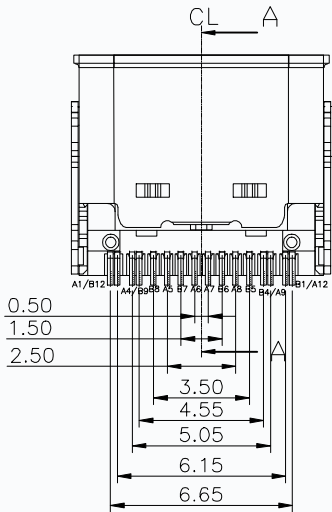
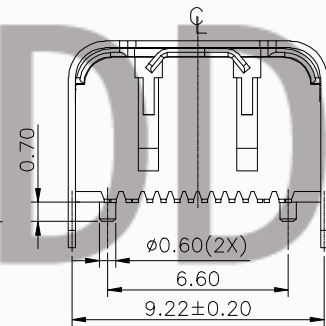
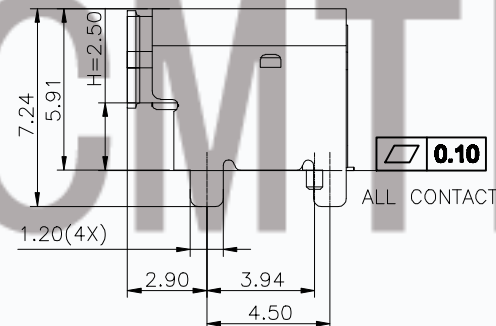
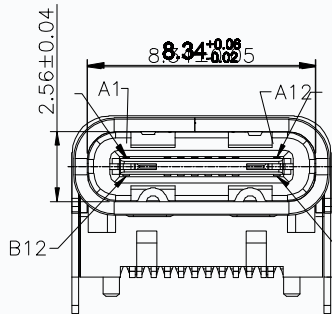

RECOMMENDED P.C.B. LAYOUT (T:0.80mm)
TOLERANCE UNSPECIFIED ±0.05mm

NOTE:

- MATERIAL SPECIFICATION:
 - HOUSING: HIGH TEMPERATURE RESISTANT PLASTIC, UL94 V-0.
 - CONTACTS: COPPER ALLOY
 - MID PLATE: STAINLESS STEEL
 - FRONT SHELL: STAINLESS STEEL
 - EMI PLATE: STAINLESS STEEL
 - TOP SHELL: STAINLESS STEEL
- PLATING SPECIFICATION:
 - CONTACTS:
 - Ni 50μ MIN. UNDER PLATED OVER ALL.
 - Au 30μ PLATED ON THE FUNCTIONAL AREA OF CONTACT.
 - Au G/F PLATED ON SOLDER AREA.
 - FRONT SHELL/TOP SHELL:
 - Ni 30μ MIN. UNDER PLATED OVER ALL.
 - SHIELD PLATE/EMI PLATE: CLEAR ONLY
- MECHANICAL PERFORMANCE:
 - INSERTION FORCE: 0.5~2.0kgf.
 - REMOVAL FORCE: 0.8kgf~2.0kgf.
 - DURABILITY: 10000 CYCLES.
- ELECTRICAL PERFORMANCE:
 - CURRENT RATING: 5.0A
VOLTAGE RATING: 5.0V
 - ILCR:
 - VBUS & GND PINS AND OTHER PINS: 40mΩ/PIN MAX.
 - SHIELD: 50mΩ/MAX.
 - ILCR MAX. CHANGE OF ALL PINS: 10mΩ.
 - INSULATION RESISTANCE: 100MΩ MIN
 - DIELECTRIC WITHSTAND VOLTAGE, AC 100V FOR 1 MINUTE.
- ENVIRONMENTAL PERFORMANCE:
 - OPERATING TEMPERATURE: -25° C~+85° C.
 - THE PEAK TEMPERATURE ON THE BOARD SHALL

USB TYPE-C PIN ASSIGNMENTS

PIN NUMBER	A1	A4	A5	A6	A7	A8	A9	A12
SIGNAL NAME	GND	Vbus	CC1	Dp1	Dn1	SBU1	Vbus	GND
PIN NUMBER	B12	B9	B8	B7	B6	B5	B4	B1
SIGNAL NAME	GND	Vbus	SBU2	Dn2	Dp2	CC2	Vbus	GND

TOLERANCE UNLESS OTHERWISE SPECIFIED	
.XX ±0.10	.X' ±3'
.XX ±0.20	.XX' ±2'
.X ±0.30	

东莞市田都科技有限公司
Dongguan Tiandu Technology Co. LTD.

APPROVED		PART NAME:	TYPE-C 16PIN母座 垫高2.5 四脚插板SMT CH=4.05 L=8.0mm			
CHECKED		PART No:	T11-16BS04A-CH4.05		C	
DRAWN	JEPF	PROJECTION:	UNIT:	SCALE:	SHEET:	REV.:
DATE	2021-03-27		mm	1:1	10F1	A