

CAD FILE:

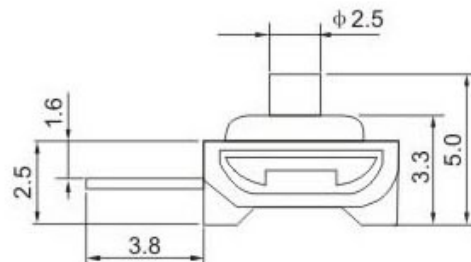

P.C.B.Land Pattern

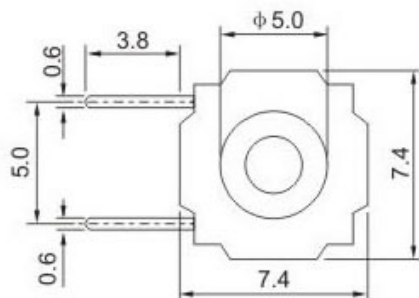
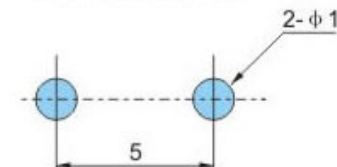

Circuit Diagram



SPECIFICATIONS

Rating	50mA 12V DC
Travel	0.25±0.1mm
Contact Resistance	≤ 100 mΩ
Operating temperature	-20℃ ~ 70℃(45% ~ 85% RH)
Operating Force	130±50/300±80/500±130gf
Operating Life	100,000 Cycles

8					TOLERANCE UNLESS SPECIFIED WITHIN 1.5mm : ±0.1mm OVER 1.5mm : ±0.2mm	THESE DRAWINGS AND SPECIFICATIONS ARE THE PROPERTY OF DONGGUAN TIANDU ELECTRONICS CO.,LTD. AND SHALL NOT BE REPRODUCED, COPIED OR USED IN ANY MANNER WITHOUT THE PRIOR WRITTEN CONSENT OF DONGGUAN TIANDU ELECTRONICS CO., LTD	DESCRIPTIONS OF REVISION			APPD.
7										
6										
5	KNOB	SILICA GEL	1	RED						
4	COVER	BRASS	1	TIN PLATED	TITLE : WATERPROOF TACT SWITCH	UNIT : mm	DRWG NO.: CMTDDZ-T6-7474M-00			
3	TERMINAL	BRASS(0.3T)	2	SILVERING	MODEL: T6-7474M	SCALE: 3:1	DWN.	ERIC	2013-6-17	
2	CONTACT	F.Ag/C5210	1	SILVER COVERED	CMTDDZ 东莞市田都电子有限公司 DONGGUAN TIANDU ELECTRONICS CO.,LTD.		CHK'D	MAIKO	2013-6-17	
1	BASE	PPA	1	BLACK			APPD.	Coco	2013-6-17	
NO.	PARTS	MATERIALS	Q'TY	FINISH						