

CAD FILE:

MODEL NO.	XX
T6-3536C-XX	16=160GF
	25=20GF

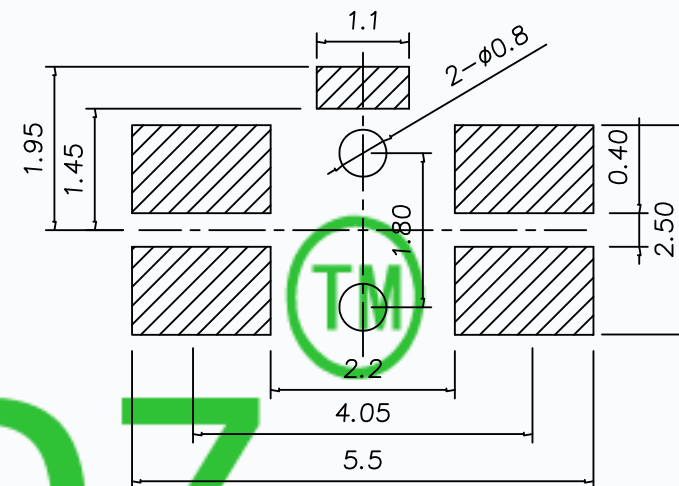
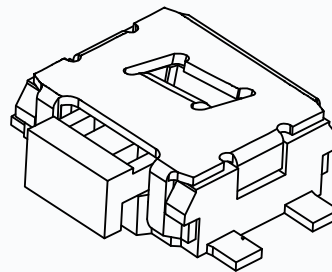
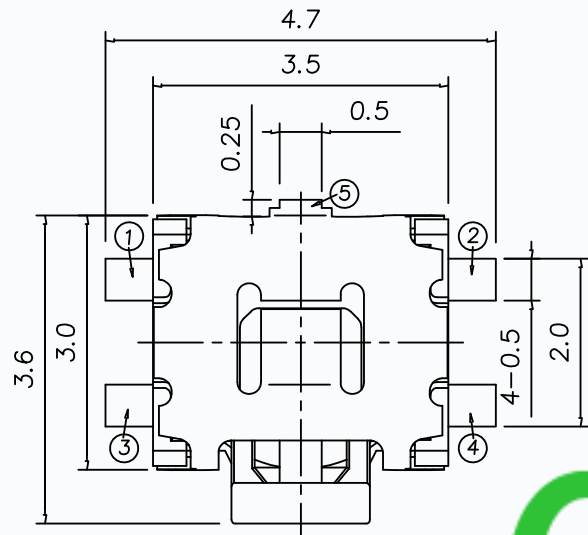

# CMTDDZ

P.C.B. LAND PATTERN

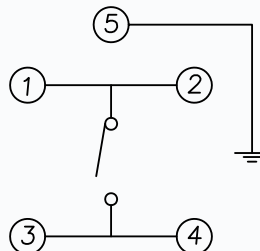
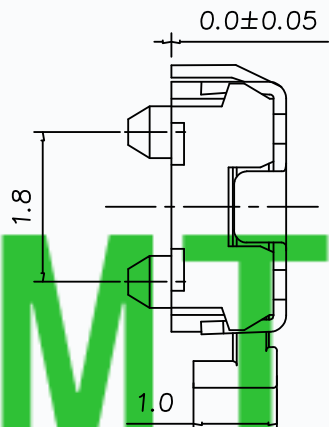
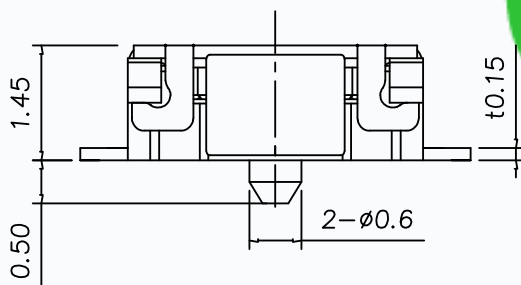

CIRCUIT DIAGRAM

### SPECIFICATIONS

Rating	50mA 12V DC
Travel	0.2±0.1mm
Contact Resistance	≤ 100 mΩ
Operating temperature	-20℃ ~ 70℃( 45% ~ 85% RH )
Operating Force	160±30gf/250±30gf
Operating Life	50,000 Cycles

NO.	PARTS	MATERIALS	Q'TY	FINISH
8				
7				
6	Cover	SUS	1	Ag Plated
5	Dust cover	PI Film	1	Yellow
4	Stem	PA	1	Black
3	Terminal	Phosphor Bronze	4	Ag Plated
2	Contact	SUS	2	Ag Clad
1	Case	PA6T	1	Black

TOLERANCE  
UNLESS SPECIFIED  
WITHIN 1.5mm : ±0.1mm  
OVER 1.5mm : ±0.2mm

THESE DRAWINGS AND SPECIFICATIONS ARE THE PROPERTY OF DONGGUAN TIANDU ELECTRONICS CO.,LTD. AND SHALL NOT BE REPRODUCED, COPIED OR USED IN ANY MANNER WITHOUT THE PRIOR WRITTEN CONSENT OF DONGGUAN TIANDU ELECTRONICS CO., LTD

DESCRIPTIONS OF REVISION

APPD.

TITLE : TACT SWITCH

UNIT : mm

DRWG NO.: CMTDDZ-T6-3536C-00

MODEL: T6-3536C-XX 帶柱

SCALE: 3:1

DWN.	ERIC	2013-6-17
CHK'D	MAIKO	2013-6-17
APPD.	Coco	2013-6-17

**CMTDDZ** 东莞市田都电子有限公司  
DONGGUAN TIANDU ELECTRONICS CO.,LTD.