

CAD FILE:

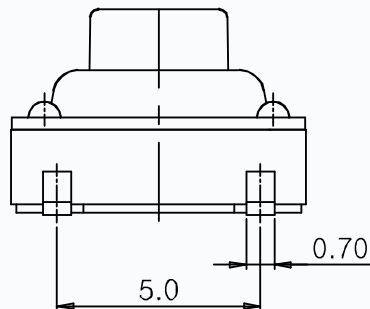

MODEL NO.	XX	H(mm)
T6-7272AS-XX-H	23=230GF	4.3
	25=250GF	4.98
		5.1
		6.9
	H(mm)	7.1
		13.0
		9.9

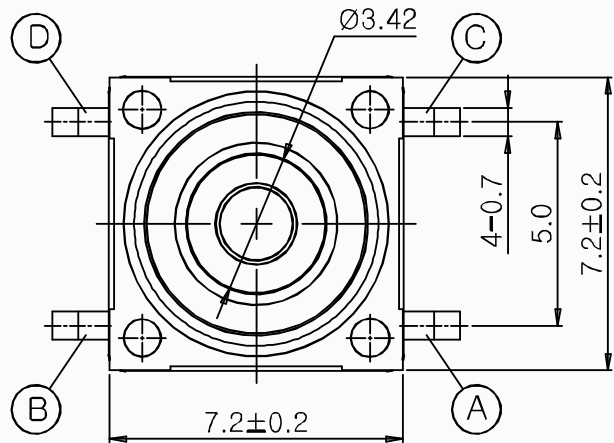
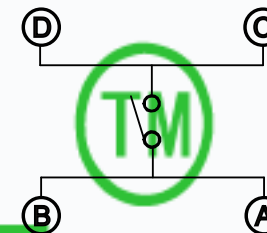
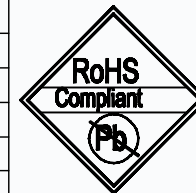

CIRCUIT DIAGRAM

CMTDDZ

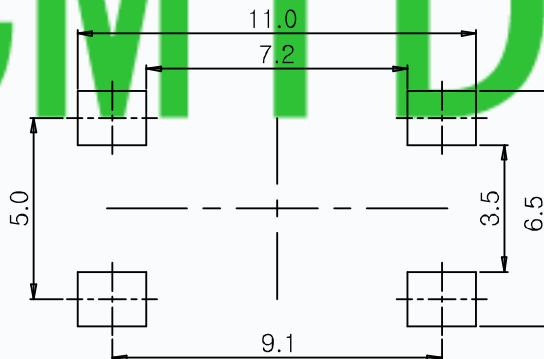
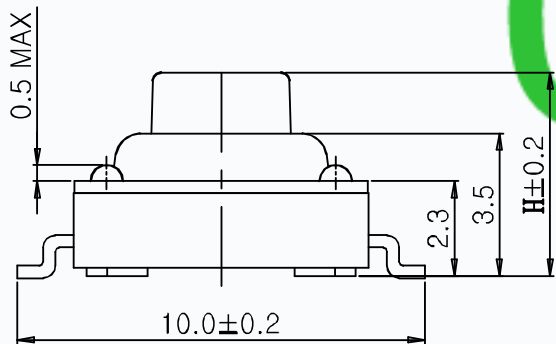

P.C.B. LAND PATTERN

SPECIFICATIONS	
Rating	50mA 12V DC
Travel	0.25±0.1mm
Contact Resistance	≤ 100 mΩ
Operating temperature	-20℃ ~ 70℃(45% ~ 85% RH)
Operating Force	230±40/250±70gf
Operating Life	100,000 Cycles
Ip Rating	IP67

NO.	PARTS	MATERIALS	Q'TY	FINISH
8				
7				
6	KNOB	NYLON	1	RED
5	COVER	BRASS	1	TIN PLATED
4	WATERPROOF SILICONE	SILICA GEL	1	BLACK
3	TERMINAL	COPPER	4	PLATING SILVER
2	CONTACT	F.Ag/SUS	1	PLATING SILVER
1	BASE	NYLON	1	BLACK

TOLERANCE UNLESS SPECIFIED		THESE DRAWINGS AND SPECIFICATIONS ARE THE PROPERTY OF DONGGUAN TIANDU ELECTRONICS CO.,LTD. AND SHALL NOT BE REPRODUCED, COPIED OR USED IN ANY MANNER WITHOUT THE PRIOR WRITTEN CONSENT OF DONGGUAN TIANDU ELECTRONICS CO., LTD	DESCRIPTIONS OF REVISION		APPD.
WITHIN 1.5mm	: ±0.1mm		TITLE : WATERPROOF SWITCH	UNIT : mm	DRWG NO.: CMTDDZ-T6-7272AS-00
OVER 1.5mm	: ±0.2mm	MODEL: T6-7272AS-XX-H	SCALE: 3:1	DWN. ERIC	2013-6-17
		CMTDDZ 东莞市田都电子有限公司		CHK'D MAIKO	2013-6-17
		DONGGUAN TIANDU ELECTRONICS CO.,LTD.		APPD. Coco	2013-6-17