

CAD FILE:

MODEL NO.	XX	H(mm)	Guide bosses
T6-1212AS-XX-H	18=180gf	7.3MM	NO
T6-1212ASG-XX-H	25=250gf		HAVE

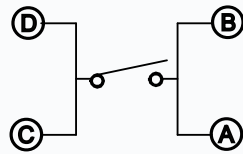

CIRCUIT DIAGRAM

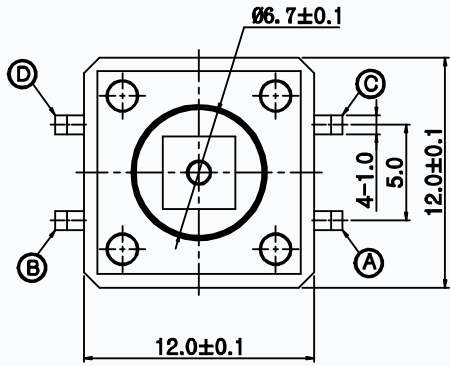
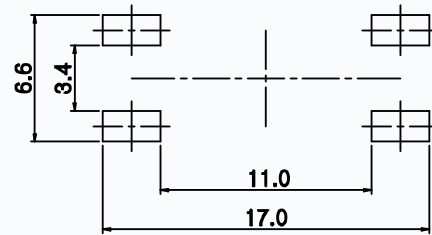

T6-1212AS-XX-H

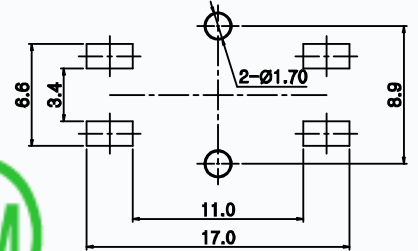

T6-1212ASG-XX-H

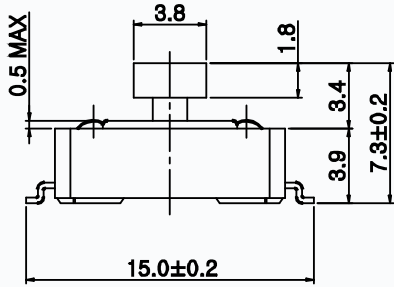

T6-1212AS-XX-H

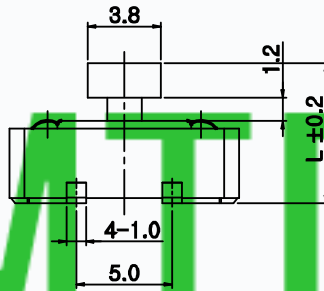

T6-1212ASG-XX-H

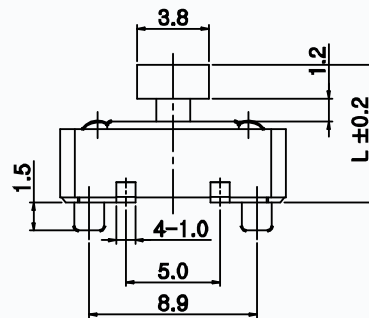

P.C.B. LAND PATTERN

CMTDDZ

SPECIFICATIONS

Rating	50mA 12V DC
Travel	0.25±0.1mm
Contact Resistance	≤ 100 mΩ
Operating temperature	-20℃ ~ 70℃(45% ~ 85% RH)
Operating Force	180±50gf/250±50gf
Operating Life	100,000 Cycles

8				
7				
6				
5	COVER	SPCC	1	PLATING NICKEL
4	KEYSTOKE	NYLON	1	BLACK/WHITE
3	TERMINAL	BRASS	4	PLATING SILVER
2	CONTACT	SUS	1	Ag CLAD
1	BASE	NYLON	1	BLACK
NO.	PARTS	MATERIALS	Q'TY	FINISH

TOLERANCE UNLESS SPECIFIED		THESE DRAWINGS AND SPECIFICATIONS ARE THE PROPERTY OF DONGGUAN TIANDU ELECTRONICS CO.,LTD. AND SHALL NOT BE REPRODUCED, COPIED OR USED IN ANY MANNER WITHOUT THE PRIOR WRITTEN CONSENT OF DONGGUAN TIANDU ELECTRONICS CO., LTD		DESCRIPTIONS OF REVISION		APPD.	
WITHIN 1.5mm : ±0.1mm				TITLE : TACT SWITCH		UNIT : mm	DRWG NO.: CMTDDZ-T6-1212AS-00
OVER 1.5mm : ±0.2mm				MODEL: T6-1212AS/ASG-XX-H		SCALE: 3:1	
		CMTDDZ 东莞市田都电子有限公司		DWN.	ERIC	2013-6-17	
		DONGGUAN TIANDU ELECTRONICS CO.,LTD.		CHK'D	MAIKO	2013-6-17	
				APPD.	Coco	2013-6-17	